

DOTHAN REGIONAL AIRPORT

Connecting Dothan To The World

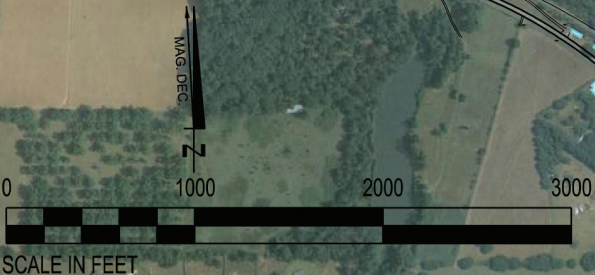



 BARGE WAGGONER SUMNER & CANNON, INC. <small>2047 West Main Street, Suite L, Dothan, Alabama 36301 PHONE: (334) 793-6266 FAX: (334) 793-4459</small>	DOTHAN REGIONAL AIRPORT		<small>DRAWN BY:</small> JEC	<small>CHECKED BY:</small> MJC
	AIRPORT LAYOUT DRAWING DOTHAN, AL		<small>DRAWING NO.:</small> 1	
			<small>PROJECT NO.:</small> 31361-10	<small>DATE:</small> 6/4/13

DOTHAN AND THE WIREGRASS AREA

Geographically located in the southeast corner of Alabama, Dothan and the surrounding area is affectionately called “The Wiregrass,” named for *Aristida stricta*, a warm-season grass native to North America that dominated the area.

Wiregrass communities include Dothan, which is one of the region’s most progressive cities. The community offers a mild winter climate, affordable housing, low property taxes and a wide variety of products and services that includes health care, education, shopping and cultural entertainment.

Located a few short miles from the state lines of Florida and Georgia, the area embraces the best that life has to offer, providing its residents not only modern conveniences and amenities of much larger cities, but also retains the charm and friendliness of the South. (courtesy Dothan Area Chamber of Commerce)

Dothan has good neighbors in the cities of Enterprise and Ozark, located just west and northwest of Dothan. The metro area is home to more than 500,000 with jobs centering in the Services (22 percent), Manufacturing (19 percent), Retail (18 percent), Government (17 percent), Construction (6 percent), Transportation (6 percent), Agriculture (4 percent), Finance (4 percent) and Trade (4 percent) sectors.

Fort Rucker, home of Army Aviation, hosts 5,000 active duty soldiers with a base population of 14,000. Additionally, major medical services are provided by Flowers Hospital, Southeast Alabama Medical Center, Dale County Medical Center and Encompass Health. Dothan is also home to the new Alabama College of Osteopathic Medicine where new physicians are trained for Alabama and the Southeast region.

The Wiregrass area boasts many venues of art and culture, and also some of the world’s best golf courses and recreation. Dothan hosts the Robert Trent Jones Golf Trail at the Highland Oaks Golf Course. The tropical climate provides a perfect place to play year round, whether you are interested in fishing, hunting, golf, swimming, tennis, baseball or softball.

The area’s municipalities manage multiple parks, outdoor swimming pools, a water park, recreation centers, tennis courts, including a 20-court fast-dry complex built to professional standards, softball complexes, baseball complexes and additional playing areas for field team sports like soccer and football. Hunting, fishing, bird watching or just the general enjoyment of the natural world can also be discovered in the region. Nearby lakes, rivers, public or private gardens, state and national parks, the Gulf of Mexico and other natural open areas will take your breath away with their beauty, simplicity and managed care.

Airport Information

Airport Data: Based Aircraft
Single Engine 36
Multi Engine 45
Jet 10

- Average Number of Annual Operations: 90,000

- FAR 139 Certificated, Fire Index B (24 hours/day) (334) 983-8103
- Security provided by Airport Police Department (334) 983-8104), backed up by City of Dothan Police Department
- Latitude: 031-19-16.821N
- Longitude: 083-26-58.664 W
- Elevation: 401 feet
- Airport Beacon: Clear/Green
- Lighted Wind Indicators, Segmented Circle
- Air Traffic Control Tower: (334-983-3133) 06:00 - 21:00 M-F and 07:00-20:00 Sat-Sun
- Flight Service Station: 1-800-WX-BRIEF or go to www.duats.com
- Unicom: 122.950
- Airport Lighting controlled by Air Traffic Control Tower during hours of operation. When ATCT is closed, RW 14-32 lighting is pilot controlled on 118.40. RW 18-36 available by prior request by calling 334-983-8100 or 334-983-8103.
- Runway 14/32
Length: 8,500 ft. / 2,590 m
Width: 150 ft.
Surface Type: Asphalt
Surface Treatment: Grooved
Gross Wt SW: 75,000 lb.
Gross Wt DW: 105,000 lb.
Gross Wt DTW: 190,000 lb.
Lighting/Approach - Edge Intensity: High
Runway Markings: PIR-G/PIR-G
PAPI/VASI: P2L/-
Threshold Cross Ht: 34/-
Visual Glide Angle: 3.00/-
RVR-RVV: -/T-N
REIL: Y/-
Approach Lights: -/MALSR
- Runway 18/36
Length: 5,000 ft. / 1,524 m
Width: 100 ft.
Surface Type: Asphalt
Surface Treatment: Grooved
Gross Wt SW: 75,000 lb.
Gross Wt DW: 105,000 lb.
Gross Wt DTW: 190,000 lb.
Lighting/Approach - Edge Intensity: High
Runway Markings: NPI-G/NPI-G
PAPI/VASI: P2L/-
Threshold Cross Ht: 26/-
Visual Glide Angle: 3.00/-
RVR-RVV: Y/-
REIL: Y/-
Approach Lights: -/-

(continued)

Airport Tenants

The following businesses or agencies are tenants of the airport:

AAA Cooper Hangar	FAA Air Traffic Control Tower
AAA Cab	
Aerostar World Inc.	FAA Airways Facility Maintenance
Avis Car Rental	
Aero-One Aviation (FBO)	Hertz Car Rental
CAE	National Car Rental
Civil Air Patrol	Qualico Steel Hangar
Commercial Jet (MRO)	Republic Airport Parking
DHN, LLC Hangar	Thompson Farms
The Dinner Bell Café	W. S. Hayes Boarding Pass Gift Shop
ExpressJet / Delta Airlines	

Dothan-Houston County Foreign Trade Zone Number 233

The Dothan Regional Airport is designated as a General Purpose Foreign Trade Zone area that allows qualifying companies to potentially benefit from some of the following:

1. Elimination of Inverted Tariffs
2. No Duty of Value-Added
3. Cash Flow Savings
4. No Duties on Military or Government Contracts
5. Reduction of Paperwork with U.S. Customs
6. Scrap Duty Savings
7. Expedited Customs Clearance utilizing the Port of Entry (Panama City Customs Office).

The Dothan-Houston County FTZ Inc. administers the grantee for this program and utilizes the FTZ Corp. Inc. out of Mobile for consulting services. For more information on this program, contact Matt Parker, Dothan Area Chamber of Commerce president, at (334) 792-5138 or refer to www.dothan.com.

Resources

Education and workforce development are high priorities in the Wiregrass area. The area boasts a wide variety of education opportunities:

- Enterprise State Community College / Alabama Aviation and Technical College – The only public two-year college in the U.S. with a mission to prepare technicians for the aviation industry. The college offers specialized training in areas of aviation maintenance, technology, flight technology, and avionics technology.
- Wallace Community College – A public two-year college located in Dothan provides training in drafting, sheet metal fabrication and riveting, and offers a Welding Technology Program, Machine Program and an Electronics and Electrical Technology Program.

- Troy University Dothan – A four-year system that offers programs and degrees in business and engineering.
- Alabama Industrial Development Training
- Embry-Riddle Campus at Fort Rucker

Utility Providers

- Natural Gas – Southeast Alabama Gas District
- Electricity – Alabama Power
- Water and Sewer – Dothan Utilities
- Telecommunication – CenturyLink , WOW and Troy Cable
- Dothan Airport Industrial Park
300 Acres (Largest Tract 100 Acres)
Runway Access Sites Available
Protective Covenants
Ready to Build
Fully Infrastructured - Electricity, Gas, Water, Sewage and Telecommunications
Full Environmental Completed

Contact Information

Dothan Regional Airport

Adam Hartzog, Airport Director
800 Airport Drive, Suite 15
Dothan, Alabama 36303
Office: (334) 983-8101
Mobile: (334) 799-2469
Email: ahartzog@flydothan.com
Website: www.flydothan.com

Dothan Area Chamber of Commerce

Matt Parker, President
P.O. Box 638
Dothan, Alabama 36301
Office: (334) 792-5138
Mobile: (334) 333-0965
Email: mattpree@aol.com
Website: www.dothan.com

Ozark-Dale County Economic Development Corp.

Veronica Crock, President
3269 U.S. Highway 231 South
Ozark, Alabama 36360
Office: (334) 443-2000
Mobile: (334) 477-4053
Email: vcrock@odedc.com
Website: www.odedc.com